



#8907

# Amazing 3 Bedroom Penthouse Apartment in Larnaca's Elite Residential Extension Aradippou (8907)

📍 Aradippou, Larnaca

€275,000 +VAT













# Overview

## Specifications

Bedrooms		Bathrooms		Covered	
 3		 2		 95 m <sup>2</sup>	
Type	Apartment				
Toilets	2				
Status	Under construction				
Year of construction	2026				
Furnished	Unfurnished				
Structure	Concrete				
Facade	Concrete				
Communal charge frequency	Monthly				
Energy efficiency rating	 A				

## Description

Amazing 3 Bedroom Penthouse Apartment in Larnaca’s Elite Residential Extension Aradippou (8907)

PRICE 275.000 +VAT

Construction is already underway, and we expect to complete this remarkable development in the next 18 months, turning our vision of extraordinary living into reality. Approximately April 2026

### ALL PROPERTIES BENEFIT FROM:

- Energy-efficient Class A Certificate
- Shared Electricity with Net Metering Photovoltaic System
- Electric Vehicle Charging Stations
- Solar Energy Panels for Eco-friendly Living
- Spacious Living Areas for Relaxation and Entertainment
- Modern, Open-plan Layout for Seamless Flow
- Large Glass-fronted Verandas with Captivating Views
- Double-glazed Windows for Insulation and Quietness
- Thermal Insulation for Energy Optimization
- Built-in Self-closing Wardrobes for Sophisticated Storage
- Designer Sanitary Ware and Kitchens for Luxury
- A Serene Environment Surrounded by Lush Greenery, Creating a Tranquil Ambiance



# Floor plans

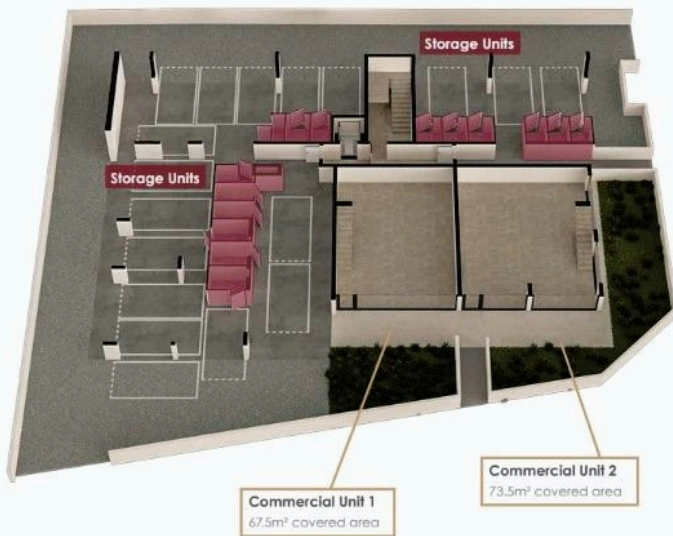

# Additional information

## Facilities

Aircondition, Provision

Parking, Covered

Elevator

Solar water heater

Heating, Provision

Storage

## Features

Balcony

Double glazing

Entrance gate, automated

Modern design

Rental potential

Thermal insulation

Combined kitchen and dining area

Easy access to main roads

Granite countertops

Open plan

Roof garden

Veranda

Connected to electric mains

Entrance gate

Investment opportunity

Pressurized water system

Shower

## Distances

Amenities

 500 m

Airport

 13.5 km

Sea

 6 km

Public transport

 700 m

Schools

 550 m

Resort

 10 km

## Contact us



**Stefania Spyridou**

 (+357) 99810880

 stephaniaSpyridou@gmail.com

