



#7422

Luxurious 2 Bedroom SeaView Apartment in Limassol Marina (7422)

📍 Limassol Marina, Limassol



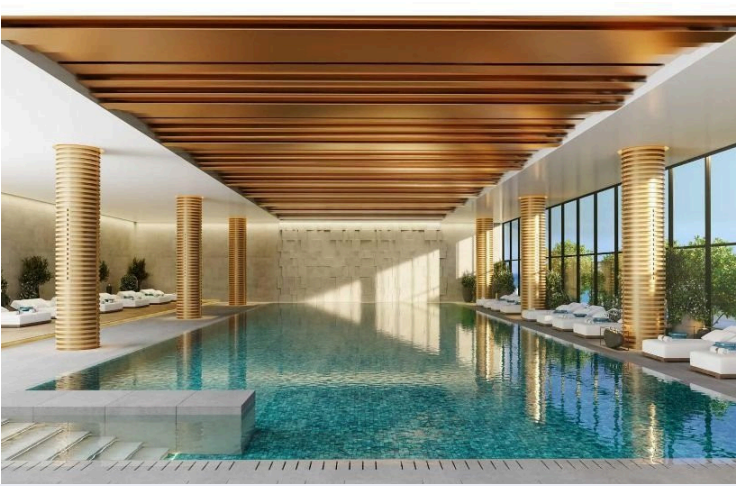

€1,359,000 +VAT





Overview

Specifications

Bedrooms		Bathrooms		Covered	
 2		 2		 156.6 m ²	
Type	Apartment				
Toilets	2				
Status	Under construction				
Year of construction	2027				
Furnished	Unfurnished				
Structure	Concrete				
Facade	Glass				
Communal charge frequency	Monthly				
Energy efficiency rating	 A				

Description

Luxurious 2 Bedroom SeaView Apartment in Limassol Marina (7422)

@EUR 1.359.000 +VAT

Welcome to the epitome of luxury living in the heart of Limassol. Nestled in the vibrant city center, this exquisite 2-bedroom SeaView apartment offers an unparalleled living experience with breathtaking panoramic vistas of the shimmering Mediterranean Sea. Imagine waking up every day to the soothing sounds of the waves and enjoying your morning coffee while gazing at the stunning sea views from the comfort of your own home.

Designed with award-winning architecture, this apartment perfectly blends contemporary elegance with the serene beauty of its surroundings. Built to the highest standards, it boasts top-quality finishes and meticulous attention to detail, ensuring an opulent living environment that is both sophisticated and comfortable.

Stunning Mediterranean Sea Views: This luxury apartment offers unobstructed views of the Mediterranean, allowing you to enjoy the beauty of the sea from sunrise to sunset. The floor-to-ceiling windows flood the apartment with natural light, highlighting the breathtaking scenery and creating an ambiance of serenity and tranquility.

Spacious En-suite Bathroom: The en-suite bathroom is a haven of luxury and comfort, featuring high-end fixtures, elegant design, and a soothing atmosphere, providing a perfect retreat to unwind after a long day.

Thermal Insulation & Double Glazing: State-of-the-art thermal insulation and double glazing ensure optimal comfort and energy efficiency, allowing you to enjoy a peaceful and climate-controlled environment year-round.



| Floor plans



Preliminary Floor Plan



Apartment 1403 / 2 Bedrooms

Preliminary Apartment Plan

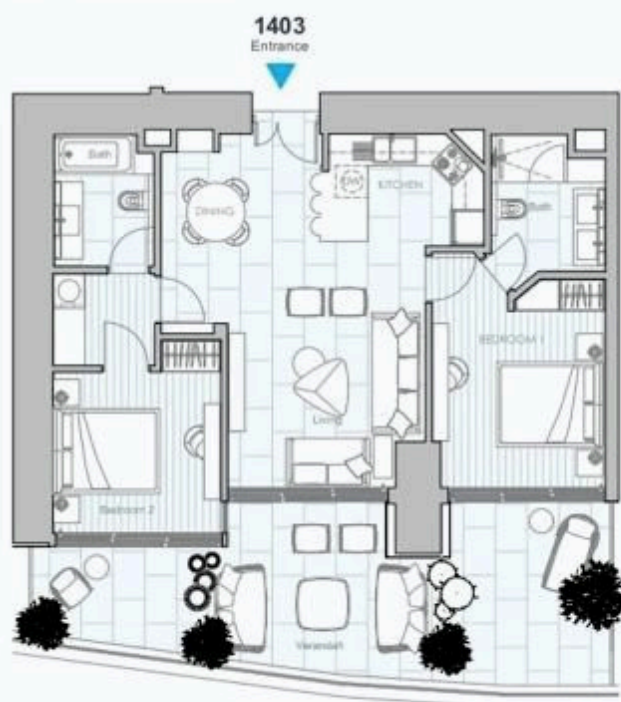

Additional information





Facilities

Aircondition, Central system	Childrens playground	Clubhouse
Elevator	Gated complex	Gym
Heating, Underfloor	Indoor pool, Communal	Parking, Underground
Pool, Communal	Sauna	Solar photovoltaic panels
Solar water heater	Spa	Storage

Features

Alarm system (provision)	Bar	Bath
Bright	CCTV (provision)	City view
Double glazing	Easy access to main roads	En suite shower
Entrance gate, automated	Fitted wardrobes	Granite countertops
Guest WC	Heart of city center	High ceilings
Luxury specifications	Modern design	Near amenities
Open plan	Panoramic view	Pressurized water system
Rental potential	Roof garden	Sea front
Sea view	Shower	Shutters, electric
Spacious rooms	Thermal insulation	Walk-in closet
Walking distance to beach		

Distances

Amenities  100 m	Sea  40 m	Public transport  100 m
Schools  700 m	Resort  90 m	



Contact us



Stefania Spyridou

 (+357) 99810880

 stephaniaspyridou@gmail.com

