



#18645

Spacious 2- Bedroom Panthea Apartment with Sea View

📍 Panthea, Limassol

€2,700 /month





Overview

Specifications

Bedrooms



2

Covered

122 m²

Type	Apartment
Showers	2
Toilets	2
Status	Key ready

Year of construction	2025
Furnished	Fully furnished
Energy efficiency rating	A

Description

Brand New Luxury 2-Bedroom Apartment with Panoramic Sea & City Views – West Panthea, Limassol

Experience elevated living in one of Limassol's most sought-after residential areas. This brand-new, fully furnished 2-bedroom apartment combines modern design, premium finishes, and breathtaking panoramic views stretching across the city skyline and the Mediterranean Sea.

Located in the quiet and prestigious West Panthea area, the property offers a perfect balance of privacy, convenience, and accessibility, just minutes from schools, the city centre, and the beach.

Property Highlights

- * 2 spacious bedrooms with built-in wardrobes and air conditioning
- * Bright open-plan living and dining area
- * Contemporary fully equipped kitchen
- * Large 5m × 5m veranda ideal for outdoor dining and entertaining
- * Underfloor heating throughout
- * Energy Efficiency Rating A
- * 65" Smart TV included
- * 24/7 hot water system
- * Covered parking space
- * Private storage room
- * Fully furnished and move-in ready



Floor plans

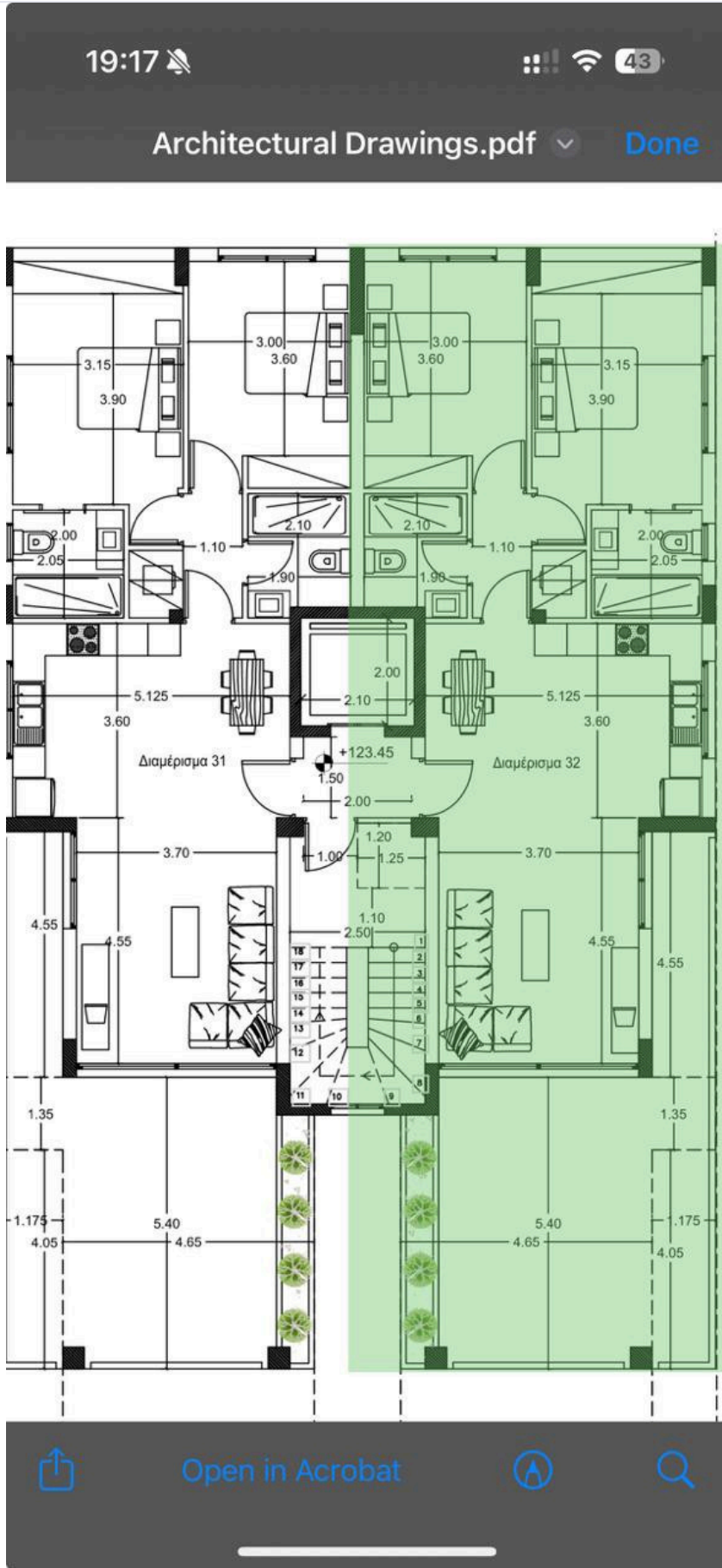

Additional information

Facilities

Aircondition, Central system

Heating, Underfloor

Solar water heater

Elevator

Parking, Covered

Storage

Gated complex

Solar photovoltaic panels

Features

Bathroom underfloor heating

Ceramic tiles

Door screen

Easy access to main roads

Energy efficient doors/windows

Floor-to-ceiling windows

Laundry room

Near amenities

Quiet area

Shower

Sound insulation

Utility room

Bright

City view

Double glazing

Elevated

Entrance gate, automated

Guest WC

Modern design

Open plan

Roller blinds

Shutters, electric

Spacious rooms

Veranda, large

CCTV

Combined kitchen and dining area

Easy access to highway

En suite shower

Fitted wardrobes

Kitchen appliances

Municipal water/sewage

Panoramic view

Sea view

Smart home automation

Tile flooring

Distances

Amenities

 500 m

Airport

 65 km

Sea

 4 km

Public transport

 1 km

Schools

 2 km

Resort

 5 km



Contact us



Elena Sokil

☎ (+357) 95759512

✉ lenasokil0@gmail.com

