



#17871

# Spacious Five Bedroom Villa with Sea View Panthea

 Panthea, Limassol

**€13,500** /month



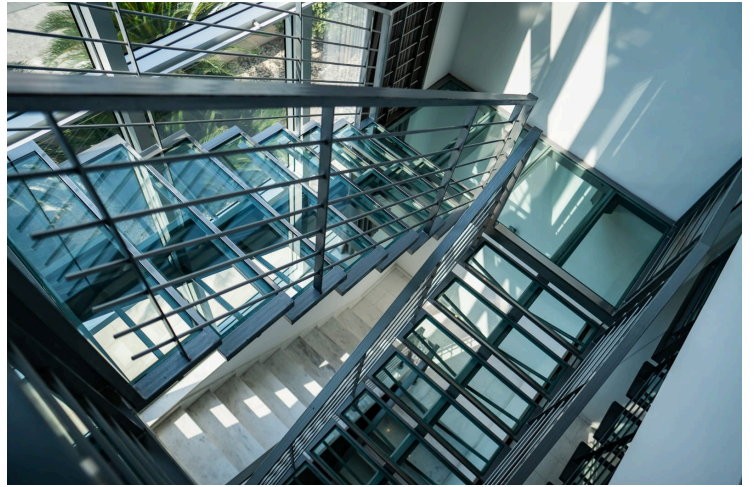

# Overview

## Specifications

Bedrooms

 5

Bathrooms

 1

Covered

 465 m<sup>2</sup>

Type	<b>Detached Villa</b>
Showers	<b>2</b>
Toilets	<b>4</b>
Plot	<b>1200 m<sup>2</sup></b>
Covered veranda	<b>150 m<sup>2</sup></b>
Uncovered veranda	<b>200 m<sup>2</sup></b>
Basement	<b>190 m<sup>2</sup></b>

Garden	<b>450 m<sup>2</sup></b>
Covered parking	<b>20 m<sup>2</sup></b>
Courtyard	<b>80 m<sup>2</sup></b>
Status	<b>Key ready</b>
Furnished	<b>Fully furnished</b>
Energy efficiency rating	 <b>A+</b>

## Description

Executive 5- Bedroom Sea-View Residence with Independent Studio & Corporate-Ready Layout – Panthea, Limassol - For Rent

Positioned in the elevated residential enclave of Panthea, this fully furnished executive residence delivers a rare combination of scale, privacy, and operational flexibility—designed specifically for corporate relocation, senior executives, and high-level professionals seeking a seamless living and working environment in Limassol.

Set on a 1,200m<sup>2</sup> private plot with unobstructed panoramic views across Limassol Bay, the property offers 465m<sup>2</sup> of internal living space across three levels, combining refined residential comfort with dedicated work, guest, and support areas.

### Designed for Executive Living

This is not a standard villa—it is a fully configured residence built to accommodate the demands of modern executive life:

- Independent studio apartment for staff, guests, or live-in support
- Dedicated office space for remote work or business operations
- Multiple flexible-use rooms adaptable as additional offices, gym, or private suites
- Full-property high-speed WiFi coverage for uninterrupted connectivity

The layout allows for clear separation between living, working, and hosting—making it ideal for professionals relocating with families or requiring a hybrid residential/work environment.

### Layout Overview



# Floor plans

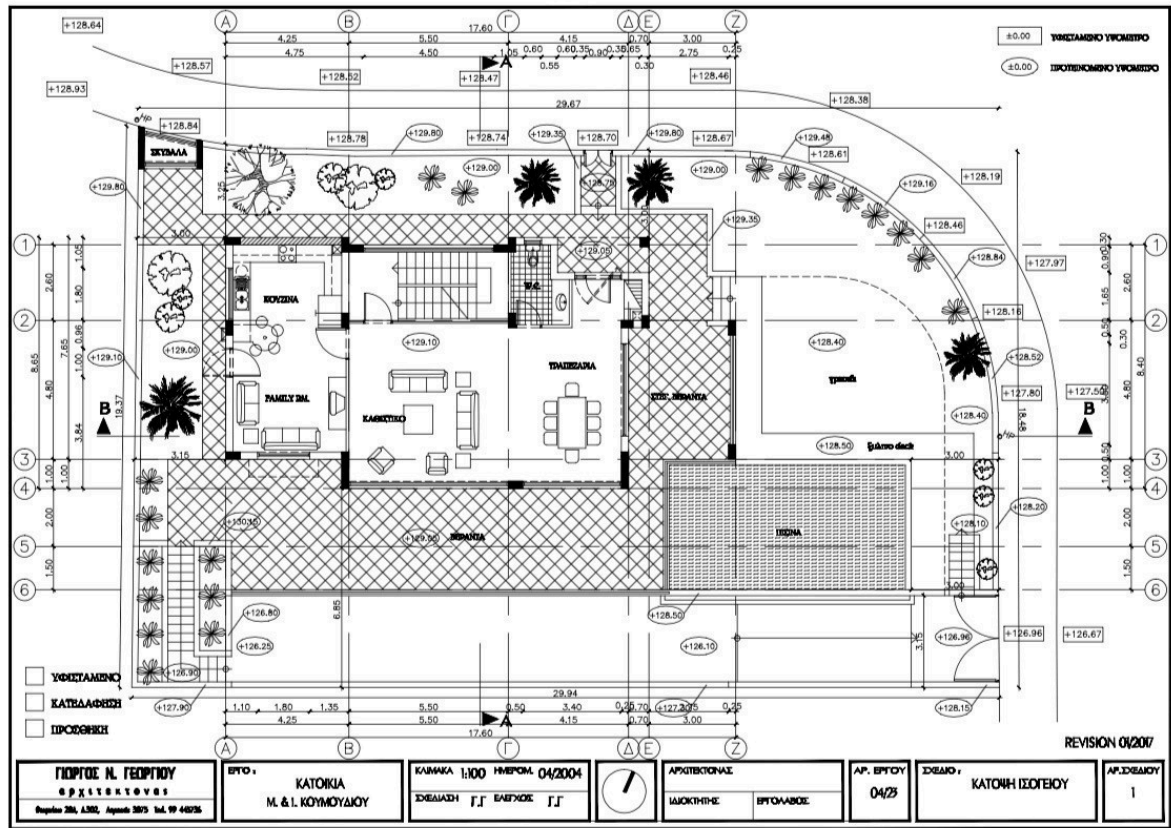
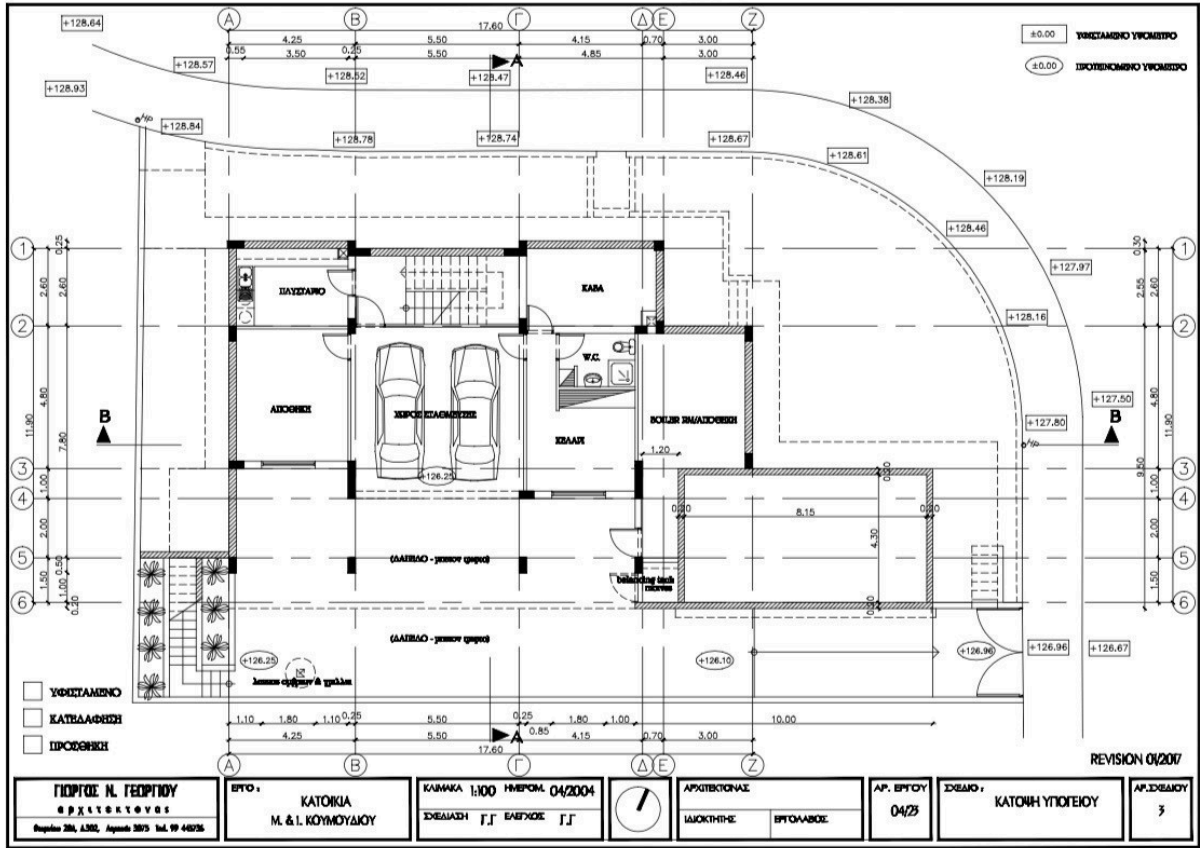

# Additional information

## Facilities

Aircondition, Split system

Maid's room

Pool, Private, heated

Storage

Heating, Central, independent

Parking, Covered

Solar photovoltaic panels

Landscaped garden

Pergola

Solar water heater



# Features

Alarm system	Attic	Balcony
Balcony, back	Balcony, front	Bar
Barbeque	Bath	Bright
Central sound system	Ceramic tiles	Courtyard
Door screen	Double glazing	Easy access to highway
Easy access to main roads	En suite bathroom	En suite shower
Energy efficient doors/windows	Entrance gate, automated	Entrance hall
Fire detector	Fitted wardrobes	Floor-to-ceiling windows
Garden, large	Granite flooring	Ground floor bedroom
Guest WC	Guest cloakroom	Guestroom
High ceilings	Home cinema	Internal stairs
Internet	Investment opportunity	Irrigation system
Kitchen appliances	Kitchen island	Kitchenette
Laminate flooring	Laundry room	Linen room
Luxury specifications	Modern design	Municipal water/sewage
Next to green area	Open plan	Openings in opposite sides
Outdoor kitchen	Panoramic view	Parquet flooring
Pool view	Pressurized water system	Quiet area
Roller blinds	Sea view	Separate dining area
Shower	Sound insulation	Spacious rooms
Suitable for work	Tile flooring	Under stairs storage
Utility room	Ventilation system	Veranda
Veranda, back	Veranda, front	Veranda, large
Walk-in closet		



## Distances

Amenities

 900 m

Airport

 54 km

Sea

 5 km

Schools

 3 km

Resort

 6.5 km

## Contact us



**Elena Sokil**

 (+357) 95759512

 lenasokil0@gmail.com

