



#16820

# Stylish Ground Floor 1-bedroom Apartment in Limassol - Mouttagiaka Tourist Area (16820)

📍 Mouttagiaka Tourist Area, Limassol

€368,000 +VAT









# Overview

## Specifications

Bedrooms		Bathrooms		Covered	
 1		 1		 55 m <sup>2</sup>	
Type		Apartment			
Toilets		1			
Covered veranda		12 m <sup>2</sup>			
Uncovered veranda		1 m <sup>2</sup>			
Status		Under construction			
Year of construction		2026			
Structure		Concrete			

## Description

Stylish Ground Floor 1-bedroom Apartment in Limassol - Mouhtagiaka Tourist Area

Price: €368,000 + VAT

Status: Under Construction

Delivery: December 2026

Discover contemporary coastal living in this bright and elegant 1-bedroom ground floor apartment, located in the highly sought-after Mouhtagiaka tourist area of Limassol.

Situated within a premium gated resort-style complex this residence offers 55m<sup>2</sup> of internal area,12m<sup>2</sup> of covered veranda and 1m<sup>2</sup> of uncovered area, thoughtfully designed to combine comfort, style, and functionality.

The spacious open-plan living area is flooded with natural light thanks to perfectly positioned windows that beautifully highlight the superior quality finishes throughout. The modern kitchen features gleaming marble or granite worktops, creating a sophisticated and inviting atmosphere that inspires culinary creativity. Double glazing, thermal insulation, aluminium frames, and laminate flooring ensure both comfort and energy efficiency.

Key features:

Ground floor apartment

1 bedroom

1 bathroom





# Floor plans

## Basement

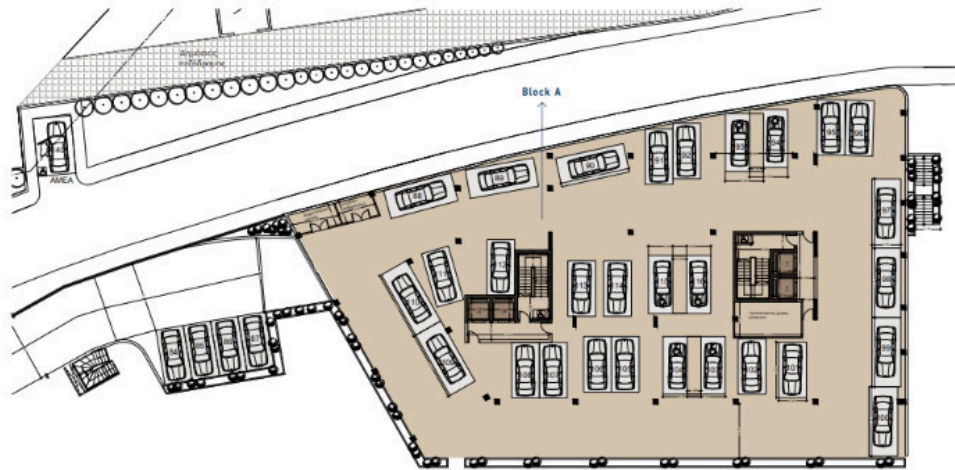

## Ground Floor



# Additional information

## Facilities

Aircondition, Provision

Heating, Provision

Parking, Covered

Gated complex

Indoor pool, Communal

Pool, Communal

Gym

Landscaped garden

Spa

## Features

Balcony

City view

Easy access to main roads

Lobby

Near amenities

Sea view

Bright

Double glazing

Electric car charger (provision)

Luxury specifications

Near bus route

Thermal insulation

Ceramic tiles

Easy access to highway

Laminate flooring

Modern design

Panoramic view

Veranda

## Contact us



**Christos Ioannides**

📞 (+357) 95146944

✉️ valantodc@gmail.com

