



#13476

Three Bedroom Semi Detached Townhouse in Georskipou Paphos (13476)

📍 Geroskipou, Paphos

€378,000 +VAT





Overview

Specifications

Bedrooms



3

Bathrooms



3

Covered

146 m²

Type	Townhouse
Toilets	3
Plot	248 m²
Covered veranda	17.5 m²
Status	Off plan

Year of construction	2027
Furnished	Unfurnished
Structure	Concrete
Facade	Concrete
Energy efficiency rating	A

Description

Price: €378,000 + VAT

Completion: 18 months from contract signing

Welcome to your future home in the sought-after area of Geroskipou, Paphos—a beautifully designed off-plan, semi-detached townhouse that combines modern elegance with functional comfort.

This off-plan, semi-detached 3-bedroom townhouse in Geroskipou, Paphos is a perfect fusion of modern architecture, thoughtful design, and practical living. Spread across two floors, the home offers 146 m² of covered space and sits on a 248 m² plot, making it ideal for families, professionals, or anyone seeking a stylish yet functional home in a growing area of Cyprus.

Upon entering, you're greeted by an open-plan living and dining area that flows seamlessly into a well-appointed kitchen, complete with granite countertops and a combined dining space—perfect for both everyday living and entertaining. Large sliding doors open out onto a spacious covered veranda, bringing in natural light and offering views of the landscaped garden.

Upstairs, you'll find three generously sized bedrooms, including a master suite with its own en-suite bathroom and private balcony. All bathrooms are finished to a high standard, with modern fixtures and thoughtful layouts.

It holds an Energy Efficiency Rating of A, and includes provisions for air conditioning and heating, along with a solar water heater—ideal for year-round living.



Floor plans

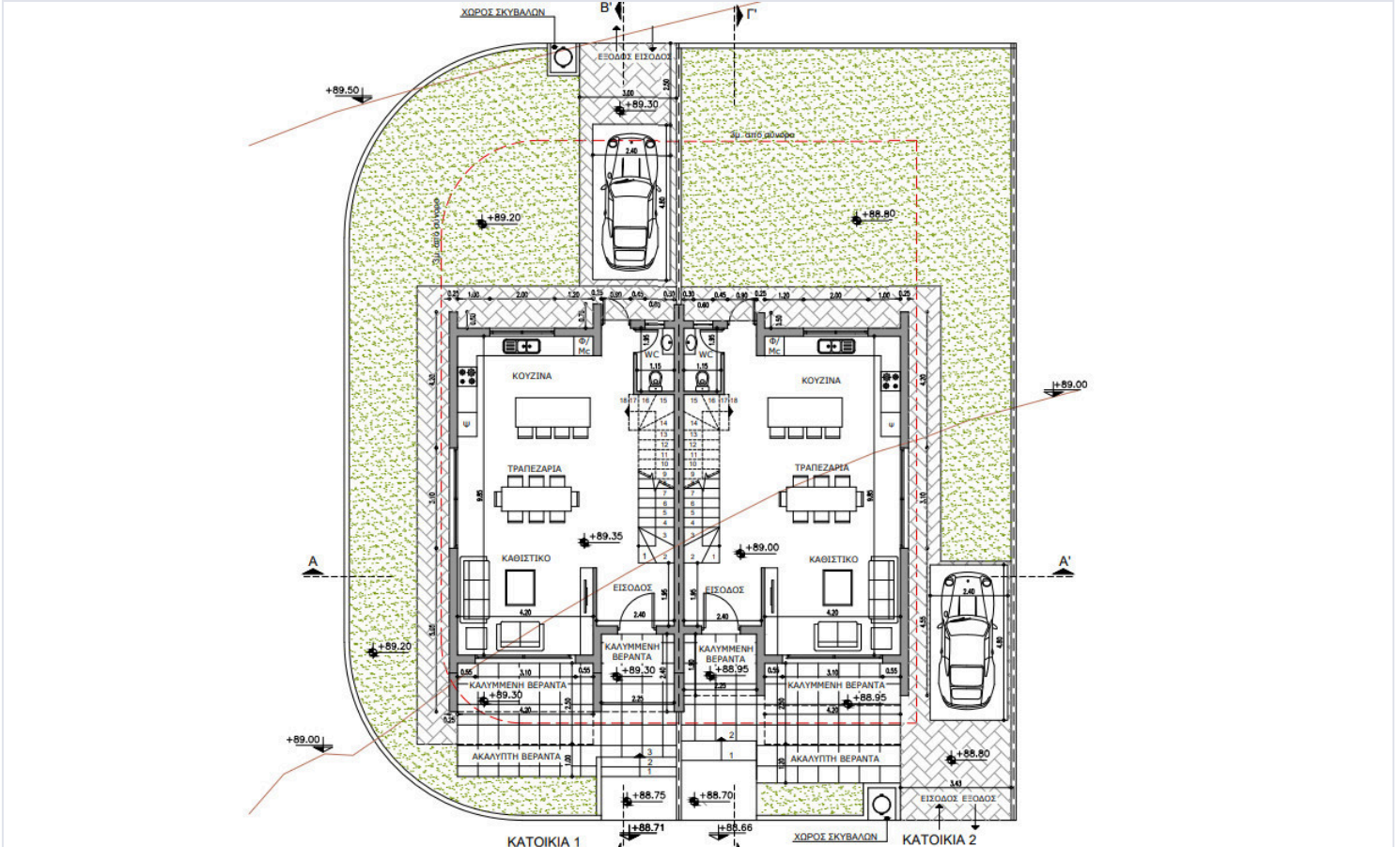
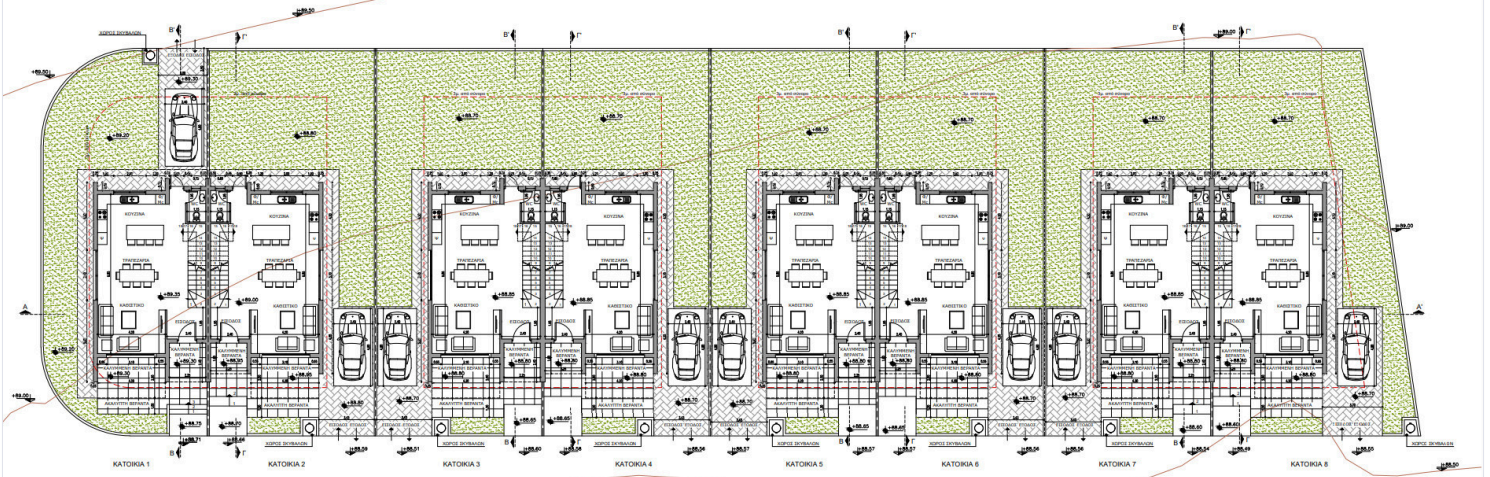

Additional information

Facilities

Aircondition, Provision

Parking, Covered

Storage

Heating, Provision

Pool, Optional

Landscaped garden

Solar water heater

Features

Balcony

Double glazing

Internal stairs

Modern design

Thermal insulation

Combined kitchen and dining area

Energy efficient doors/windows

Investment opportunity

Open plan

Veranda

Connected to electric mains

Granite countertops

Luxury specifications

Spacious rooms

Veranda, large

Contact us



Stavroula Michail

 (+357) 99810880

 stavroulamichail.lextrus@gmail.com

